

Central Lancashire Local Plan Issues and Options Consultation

November 2019

Annex 4 – Site Proposals in South Ribble: Middleforth



Introduction

As set out in Section 8 of the Central Lancashire Local Plan Issues and Options Consultation document (November 2019), we are currently looking for land to provide new homes, jobs and facilities in Central Lancashire to meet the predicted needs of a growing population, to 2036.

This section of the Annex comprises all sites which have been put forward for consideration in the South Ribble area in this specific ward. These site suggestions were submitted through two Call for Sites exercises, during which stakeholders (including interested bodies such as landowners, developers and the public) had the opportunity to present land in their interest or ownership that was considered potentially suitable for future development. In addition, further sites were suggested by public bodies, which have also been included in this Annex for consideration.

We are seeking your comments on what has been submitted, and which sites you think should be taken forward.

How to Read this Document

Sites are first grouped into electoral wards in South Ribble, then listed by their SHELAA reference in ascending order. (The SHELAA refers to the Strategic Housing and Employment Land Availability Assessment, the exercise that was undertaken prior to the sites being presented at this Issues and Options stage.)

If you are looking for a specific site with a Call for Sites reference (e.g. CLCFS00001) you can find its corresponding SHELAA reference in the table to cross reference. If sites do not have a Call for Sites reference, these are sites which have been added in by South Ribble Council.

All sites are pictured with a thick boundary colouration and hashing specific to their proposal type, these are detailed below. Sites also have an inset map in the bottom left corner, which shows the surrounding area at a larger scale to better display the area in context. All sites are shown at a scale appropriate to the size of the site, [see this Ordnance Survey \(OS\) guide to map scales](#) for help. North is always at the top of the page, indicated by the North arrow in the bottom right corner.

Legend

Colours, Hashing and Categories



Employment



Housing



Mixed Use: Housing and Employment



Other



Protection



In addition to the proposal types shown on the legend above, some maps show this background. This is a base map image from the Ordnance Survey, used to show areas which are currently under construction.

Inset Map



North Arrow and Map Scale

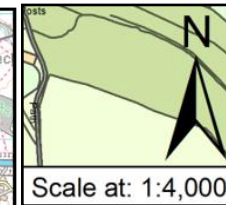

If you need any help to understand this document or wish to contact us about any corrections, please contact the Central Lancashire Team by phone on 01257 515555, email us at centrallancashireplan@chorley.gov.uk, or write to us at: Civic Offices, Union Street, Chorley, PR7 1AL.

Site Plans: Middleforth Ward, South Ribble

This section includes plans of the following sites.

Call for Sites Reference	SHELAA Reference	Site Address	District	Ward	Site Area (Hectares)	Existing Use	Proposal
CLCFS00481b	19S137	Land off Penwortham Way & Pope Lane, Penwortham, PR1 9FS	South Ribble	Middleforth	3.32	Vacant	Housing
<i>Not applicable</i>	19S162	South of Factory Lane and East of the West Coast Main Line, PR1 9TE	South Ribble	Middleforth	13.14	Vacant	Mixed Use: Housing and Employment
<i>Not applicable</i>	19S172	15 Studholme Crescent, Penwortham, PR1 9ND	South Ribble	Middleforth	0.20	Residential	Housing
<i>Not applicable</i>	19S181	Land Between 27-29 Park Lane, Penwortham, PR1 9JB	South Ribble	Middleforth	0.05	Agriculture	Housing
<i>Not applicable</i>	19S215	South of Factory Lane, East of West Coast mainline, PR1 9TE	South Ribble	Middleforth	3.90	Vacant	Housing
<i>Not applicable</i>	19S226	South of Factory Lane, East of West Coast Mainline (North Part of S1), PR1 5TE	South Ribble	Middleforth	5.35	Vacant	Housing
<i>Not applicable</i>	19S227	Land at Factory Lane, PR1 9TD	South Ribble	Middleforth	2.40	Vacant	Housing

SHELAA REFERENCE	19S137	CALL FOR SITES REFERENCE	CLCFS00481b	DISTRICT	South Ribble	WARD	Middleforth
ADDRESS	Land off Penwortham Way & Pope Lane, Penwortham, PR1 9FS						
EXISTING USE	Vacant	SITE AREA	3.32	PROPOSAL	Housing	PAGE NUMBER	5

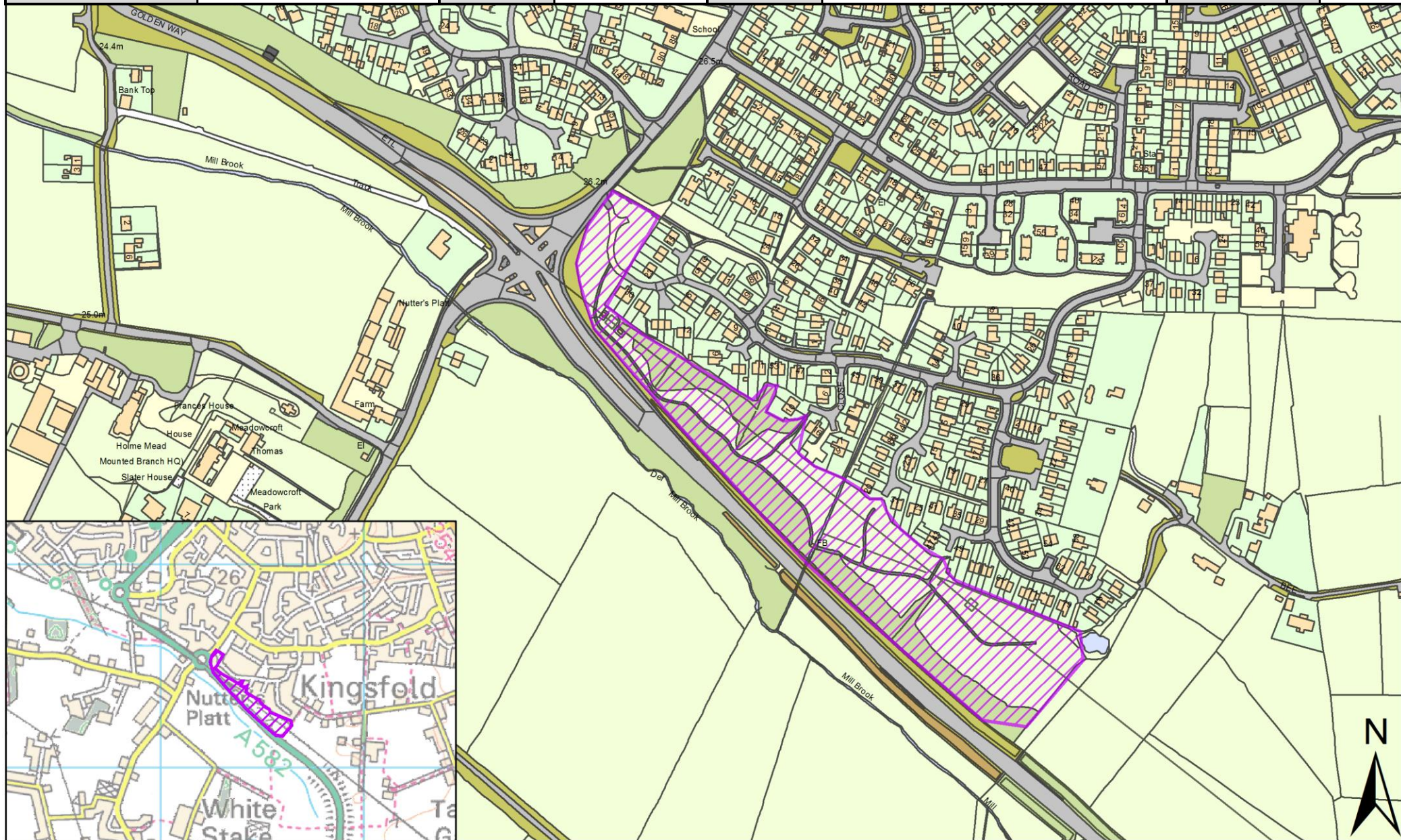

SHELAA REFERENCE	19S162	CALL FOR SITES REFERENCE	Not applicable	DISTRICT	South Ribble	WARD	Middleforth
ADDRESS	South of Factory Lane and East of the West Coast Main Line, PR1 9TE						
EXISTING USE	Vacant	SITE AREA	13.14	PROPOSAL	Mixed Use: Housing and Employment	PAGE NUMBER	6

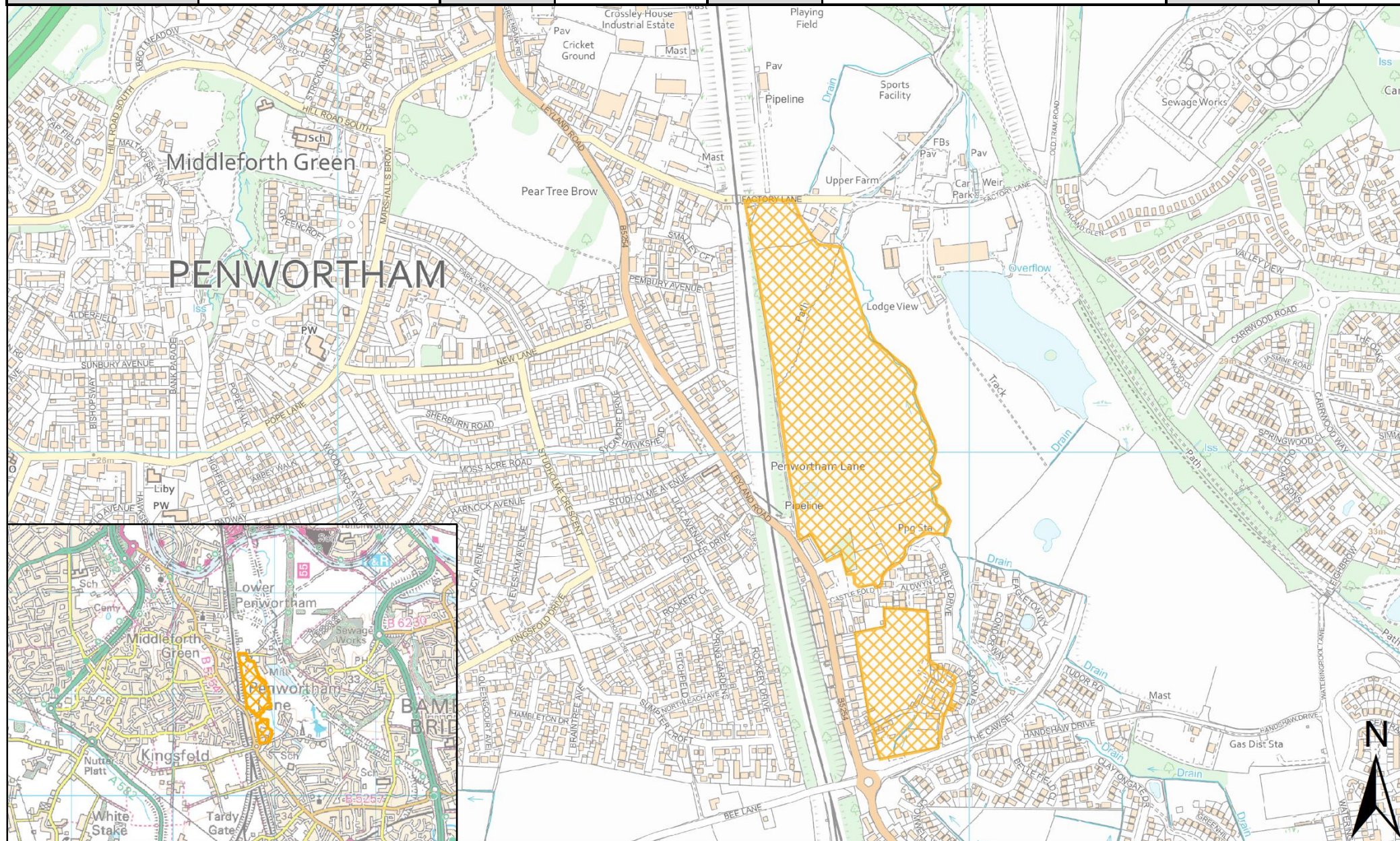

SHELAA REFERENCE	19S172	CALL FOR SITES REFERENCE	Not applicable	DISTRICT	South Ribble	WARD	Middleforth
ADDRESS	15 Studholme Crescent, Penwortham, PR1 9ND						
EXISTING USE	Residential	SITE AREA	0.20	PROPOSAL	Housing	PAGE NUMBER	7

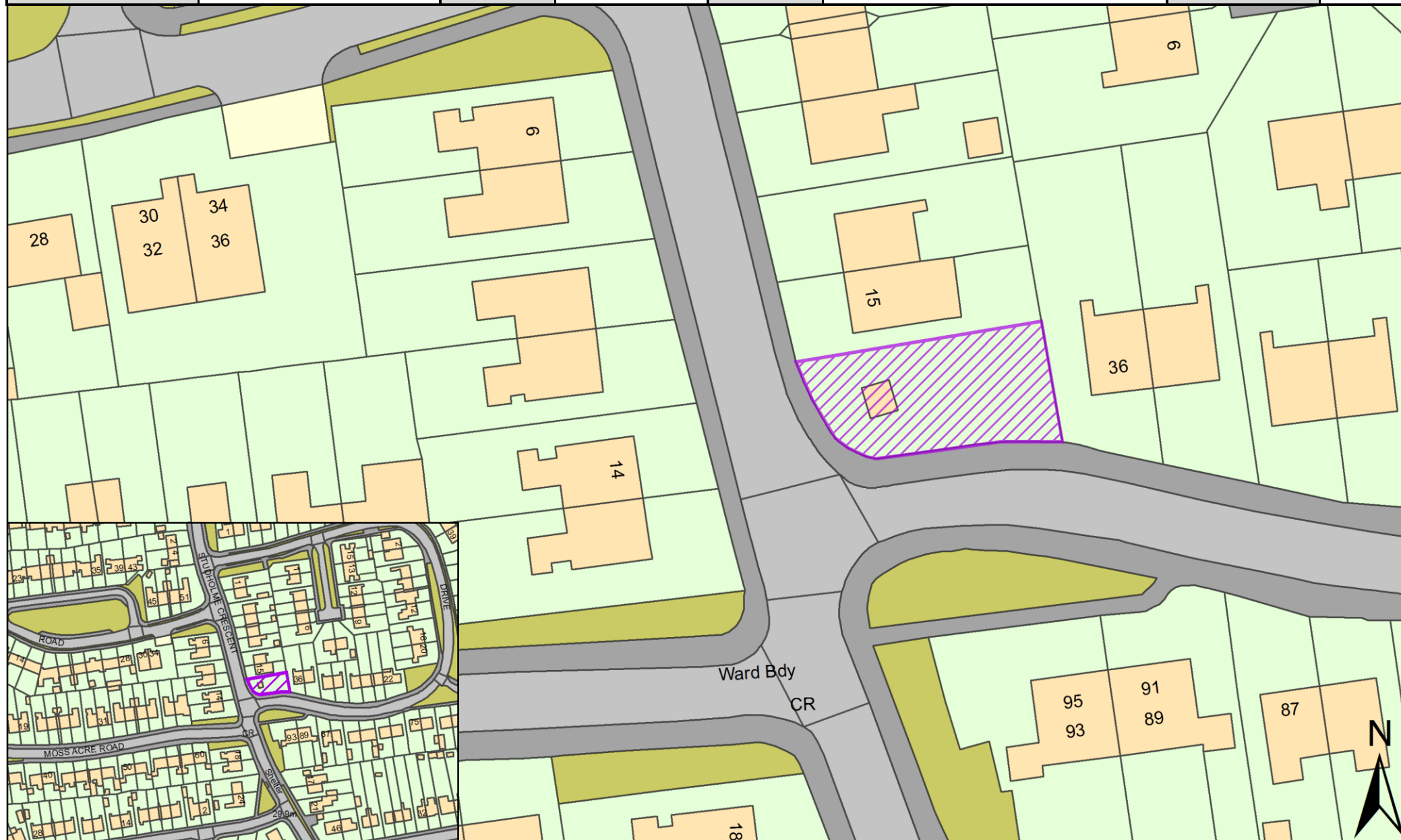

SHELAA REFERENCE	19S181	CALL FOR SITES REFERENCE	Not applicable	DISTRICT	South Ribble	WARD	Middleforth
ADDRESS	Land Between 27-29 Park Lane, Penwortham, PR1 9JB						
EXISTING USE	Agriculture	SITE AREA	0.05	PROPOSAL	Housing	PAGE NUMBER	8

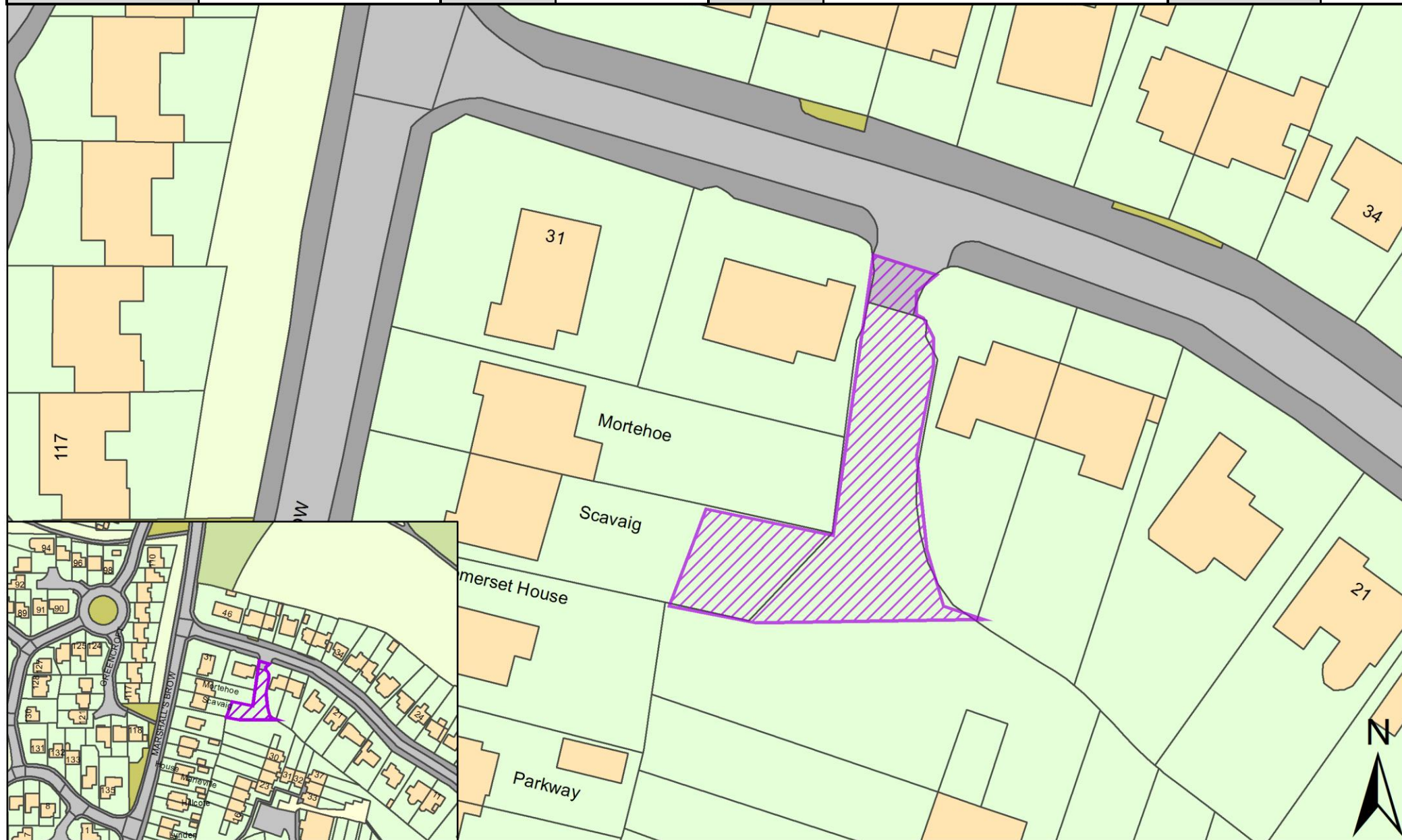

SHELAA REFERENCE	19S215	CALL FOR SITES REFERENCE	Not applicable	DISTRICT	South Ribble	WARD	Middleforth
ADDRESS	South of Factory Lane, East of West Coast mainline, PR1 9TE						
EXISTING USE	Vacant	SITE AREA	3.90	PROPOSAL	Housing	PAGE NUMBER	9

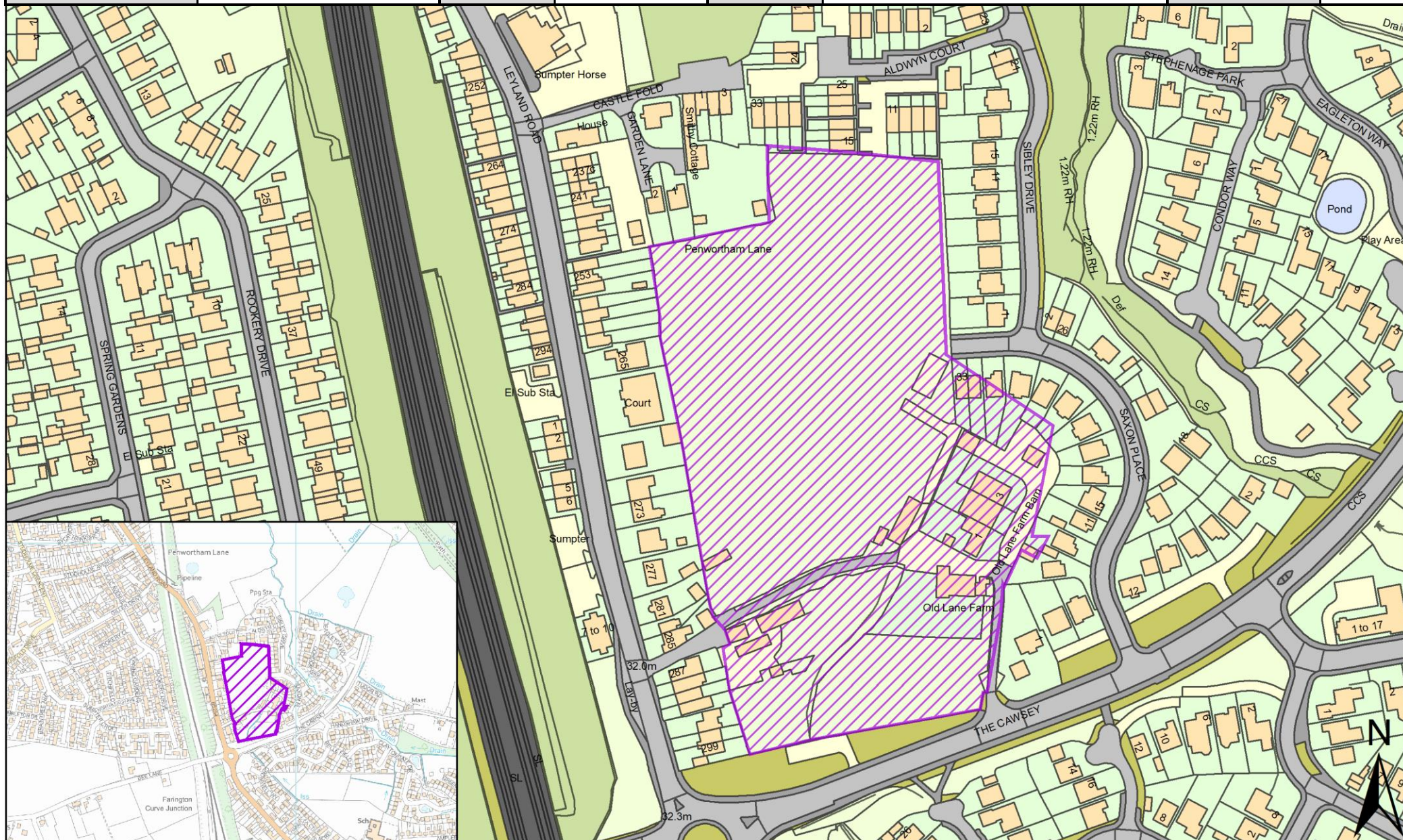

SHELAA REFERENCE	19S226	CALL FOR SITES REFERENCE	Not applicable	DISTRICT	South Ribble	WARD	Middleforth
ADDRESS	South of Factory Lane, East of West Coast Mainline (North Part of S1), PR1 5TE						
EXISTING USE	Vacant	SITE AREA	5.35	PROPOSAL	Housing	PAGE NUMBER	10

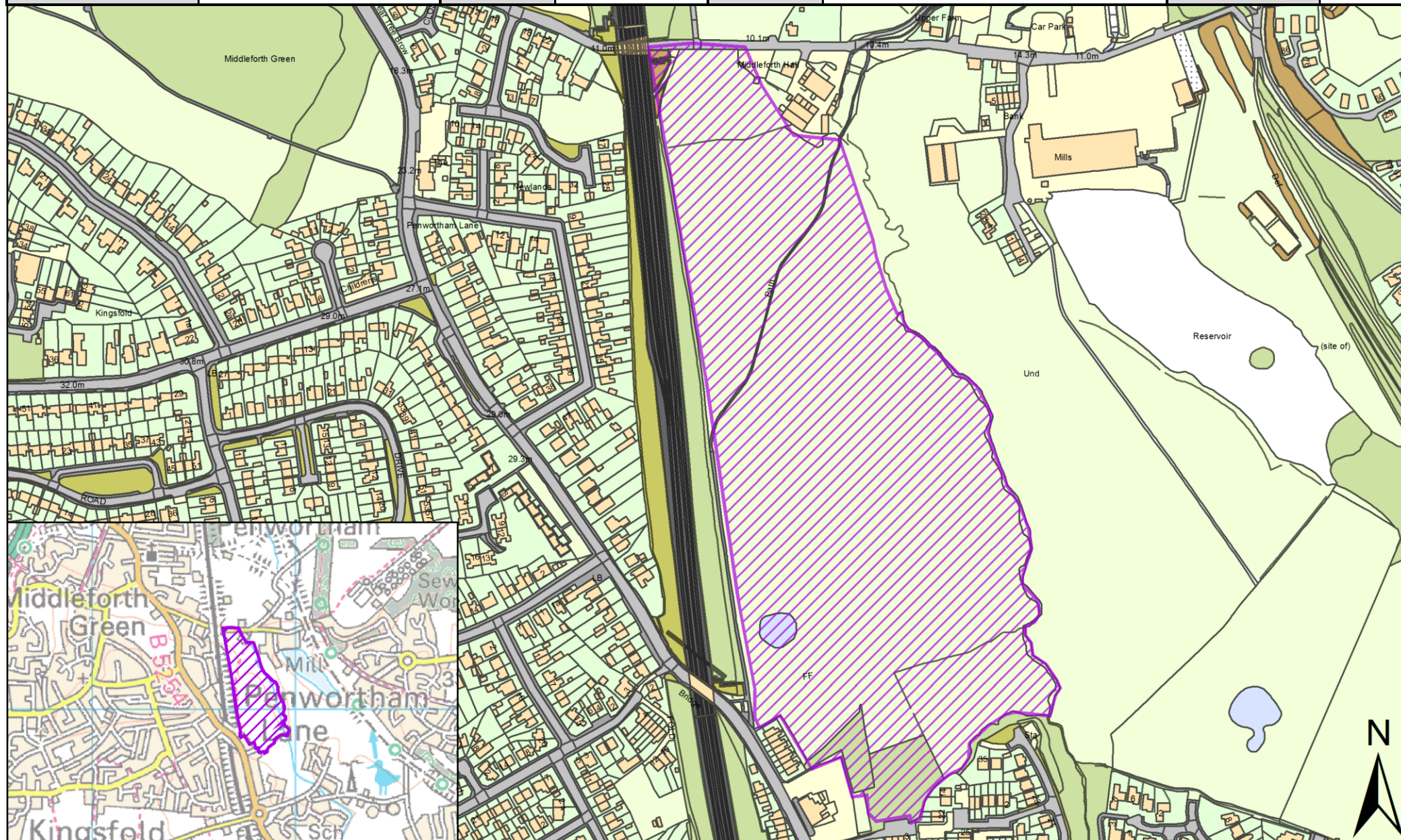

SHELAA REFERENCE	19S227	CALL FOR SITES REFERENCE	Not applicable	DISTRICT	South Ribble	WARD	Middleforth
ADDRESS	Land at Factory Lane, PR1 9TD						
EXISTING USE	Vacant	SITE AREA	2.40	PROPOSAL	Housing	PAGE NUMBER	11

