

Central Lancashire Local Plan Issues and Options Consultation

November 2019

Annex 3 – Site Submissions Received for Preston: Deepdale



Introduction

As set out in Section 8 of the Central Lancashire Local Plan Issues and Options Consultation document (November 2019), we are currently looking for land to provide new homes, jobs and facilities in Central Lancashire to meet the predicted needs of a growing population, to 2036.

This section of the Annex comprises all sites which have been put forward for consideration in the Preston area in this specific ward. These site suggestions were submitted through two Call for Sites exercises, during which stakeholders (including interested bodies such as landowners, developers and the public) had the opportunity to present land in their interest or ownership that was considered potentially suitable for future development. In addition, further sites were suggested by public bodies, which have also been included in this Annex for consideration.

We are seeking your comments on what has been submitted, and which sites you think should be taken forward.

How to Read this Document

Sites are first grouped into electoral wards in Preston, then listed by their SHELAA reference in ascending order. (The SHELAA refers to the Strategic Housing and Employment Land Availability Assessment, the exercise that was undertaken prior to the sites being presented at this Issues and Options stage.)

If you are looking for a specific site with a Call for Sites reference (e.g. CLCFS00001) you can find its corresponding SHELAA reference in the table to cross reference. If sites do not have a Call for Sites reference, these are sites which have been added in by Preston City Council.

All sites are pictured with a thick boundary colouration and hashing specific to their proposal type, these are detailed below. Sites also have an inset map in the bottom left corner, which shows the surrounding area at a larger scale to better display the area in context. All sites are shown at a scale appropriate to the size of the site, [see this Ordnance Survey \(OS\) guide to map scales](#) for help. North is always at the top of the page, indicated by the North arrow in the bottom right corner.

Legend

Colours, Hashing and Categories



Employment



Housing



Mixed Use: Housing and Employment



Other



Protection



In addition to the proposal types shown on the legend above, some maps show this background. This is a base map image from the Ordnance Survey, used to show areas which are currently under construction.

Inset Map



North Arrow and Map Scale

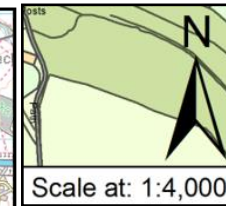

If you need any help to understand this document or wish to contact us about any corrections, please contact the Central Lancashire Team by phone on 01257 515555, email us at centrallancashireplan@chorley.gov.uk, or write to us at: Civic Offices, Union Street, Chorley, PR7 1AL.

Sites in Deepdale Ward

All sites put forward for this ward are listed below.

Call for Sites Reference	SHELAA Reference	Site Address	District	Ward	Site Area (Hectares)	Existing Use	Proposal
CLCFS00421	19P076	Moor Park Tennis Courts, Moor Park Avenue, Preston, PR1 6AS	Preston	Deepdale	1.21	Other	Housing
CLCFS00429	19P083	Moor Park Depot, Moor Park Avenue, Preston, PR1 6LN	Preston	Deepdale	1.21	Employment	Housing
	19P145	Argyll Road Depot, PR1 6AF	Preston	Deepdale	4.30	Vacant	Other

SHELAA Reference	19P083	Call for Sites Reference	CLCFS00429	DISTRICT	Preston	WARD	Deepdale
Address	Moor Park Depot, Moor Park Avenue, Preston, PR1 6LN						
Existing Use	Employment	SITE AREA	1.21	PROPOSAL	Housing	PAGE NUMBER	6

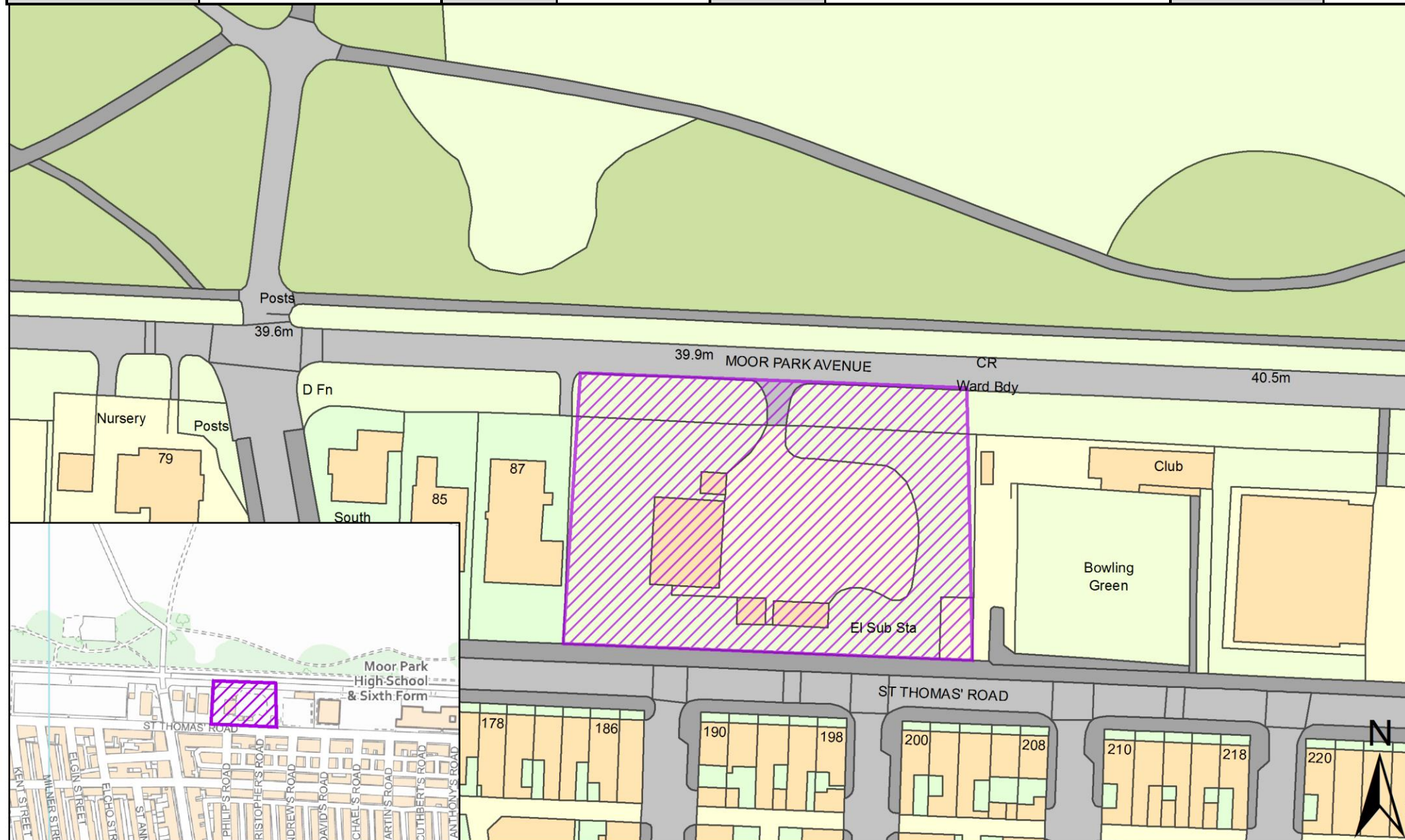

SHELAA Reference	19P145	Call for Sites Reference	Not Applicable	DISTRICT	Preston	WARD	Deepdale
Address	Argyll Road Depot, PR1 6AF						
Existing Use	Vacant	SITE AREA	4.30	PROPOSAL	Other	PAGE NUMBER	7

