

# Central Lancashire Local Plan Issues and Options Consultation

*November 2019*

## Annex 3 – Site Submissions Received for Preston: Ashton



## Introduction

As set out in Section 8 of the Central Lancashire Local Plan Issues and Options Consultation document (November 2019), we are currently looking for land to provide new homes, jobs and facilities in Central Lancashire to meet the predicted needs of a growing population, to 2036.

This section of the Annex comprises all sites which have been put forward for consideration in the Preston area in this specific ward. These site suggestions were submitted through two Call for Sites exercises, during which stakeholders (including interested bodies such as landowners, developers and the public) had the opportunity to present land in their interest or ownership that was considered potentially suitable for future development. In addition, further sites were suggested by public bodies, which have also been included in this Annex for consideration.

We are seeking your comments on what has been submitted, and which sites you think should be taken forward.

## How to Read this Document

Sites are first grouped into electoral wards in Preston, then listed by their SHELAA reference in ascending order. (The SHELAA refers to the Strategic Housing and Employment Land Availability Assessment, the exercise that was undertaken prior to the sites being presented at this Issues and Options stage.)

If you are looking for a specific site with a Call for Sites reference (e.g. CLCFS00001) you can find its corresponding SHELAA reference in the table to cross reference. If sites do not have a Call for Sites reference, these are sites which have been added in by Preston City Council.

All sites are pictured with a thick boundary colouration and hashing specific to their proposal type, these are detailed below. Sites also have an inset map in the bottom left corner, which shows the surrounding area at a larger scale to better display the area in context. All sites are shown at a scale appropriate to the size of the site, [see this Ordnance Survey \(OS\) guide to map scales](#) for help. North is always at the top of the page, indicated by the North arrow in the bottom right corner.

### Legend

#### Colours, Hashing and Categories



Employment



Housing



Mixed Use: Housing and Employment



Other



Protection



In addition to the proposal types shown on the legend above, some maps show this background. This is a base map image from the Ordnance Survey, used to show areas which are currently under construction.

#### Inset Map



#### North Arrow and Map Scale

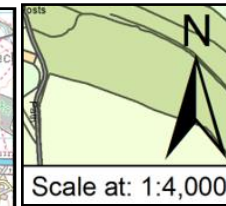

If you need any help to understand this document or wish to contact us about any corrections, please contact the Central Lancashire Team by phone on 01257 515555, email us at [centrallancashireplan@chorley.gov.uk](mailto:centrallancashireplan@chorley.gov.uk), or write to us at: Civic Offices, Union Street, Chorley, PR7 1AL.

## Sites in Ashton Ward

All sites put forward for this ward are listed below.

Call for Sites Reference	SHELAA Reference	Site Address	District	Ward	Site Area (Hectares)	Existing Use	Proposal
CLCFS00057	19P003	Land at Willowfield Barn, Cottam Lane, Preston, PR2 1JS	Preston	Ashton	1.63	Vacant	Housing
CLCFS00136	19P012	Former Alstom Works and Wider Site, Channel Way, Preston, PR1 8XL	Preston	Ashton	5.98	Employment	Mixed Use: Housing and Employment
	19P140	Riversway, J N Civils Limited, D2, Chain Caul Road, Preston, PR2 2PD (also PR2 2XL)	Preston	Ashton	1.37	Other	Employment
	19P155	Brethrens Meeting Room, Egerton Road, PR2 1AJ	Preston	Ashton	0.50	Other	Housing
	19P178	Riversway Phase B Site Specific Policy, Maritime Way, Preston, PR2 2HT	Preston	Ashton	21.44	Other	Mixed Use: Housing and Employment
	19P198	Alstoms, Strand Road, PR1 8UG	Preston	Ashton	5.87	Mixed Use	Mixed Use: Housing and Employment
	19P212	147 A Waterloo Road, PRESTON, PR2 1EP	Preston	Ashton	0.02	Vacant	Housing
	19P228	507 Blackpool Road, Preston, PR2 1EQ	Preston	Ashton	0.10	Vacant	Housing

SHELAA Reference	19P003	Call for Sites Reference	CLCFS00057	DISTRICT	Preston	WARD	Ashton
Address	Land at Willowfield Barn, Cottam Lane, Preston, PR2 1JS						
Existing Use	Vacant	SITE AREA	1.63	PROPOSAL	Housing		PAGE NUMBER 5

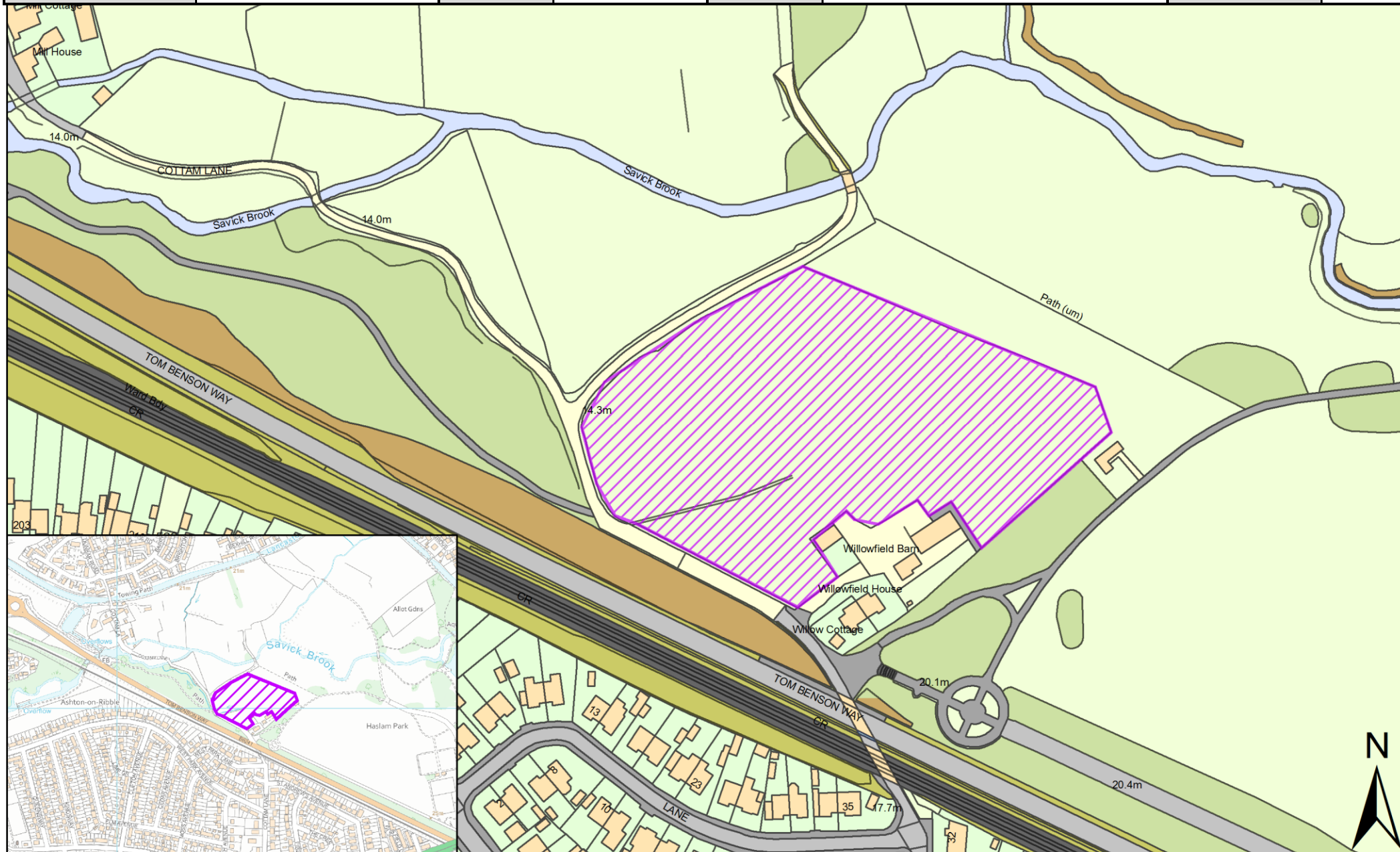



SHELAA Reference	19P012	Call for Sites Reference	CLCFS00136	DISTRICT	Preston	WARD	Ashton
Address	Former Alstom Works and Wider Site, Channel Way, Preston, PR1 8XL						
Existing Use	Employment	SITE AREA	5.98	PROPOSAL	Mixed Use: Housing and Employment	PAGE NUMBER	6

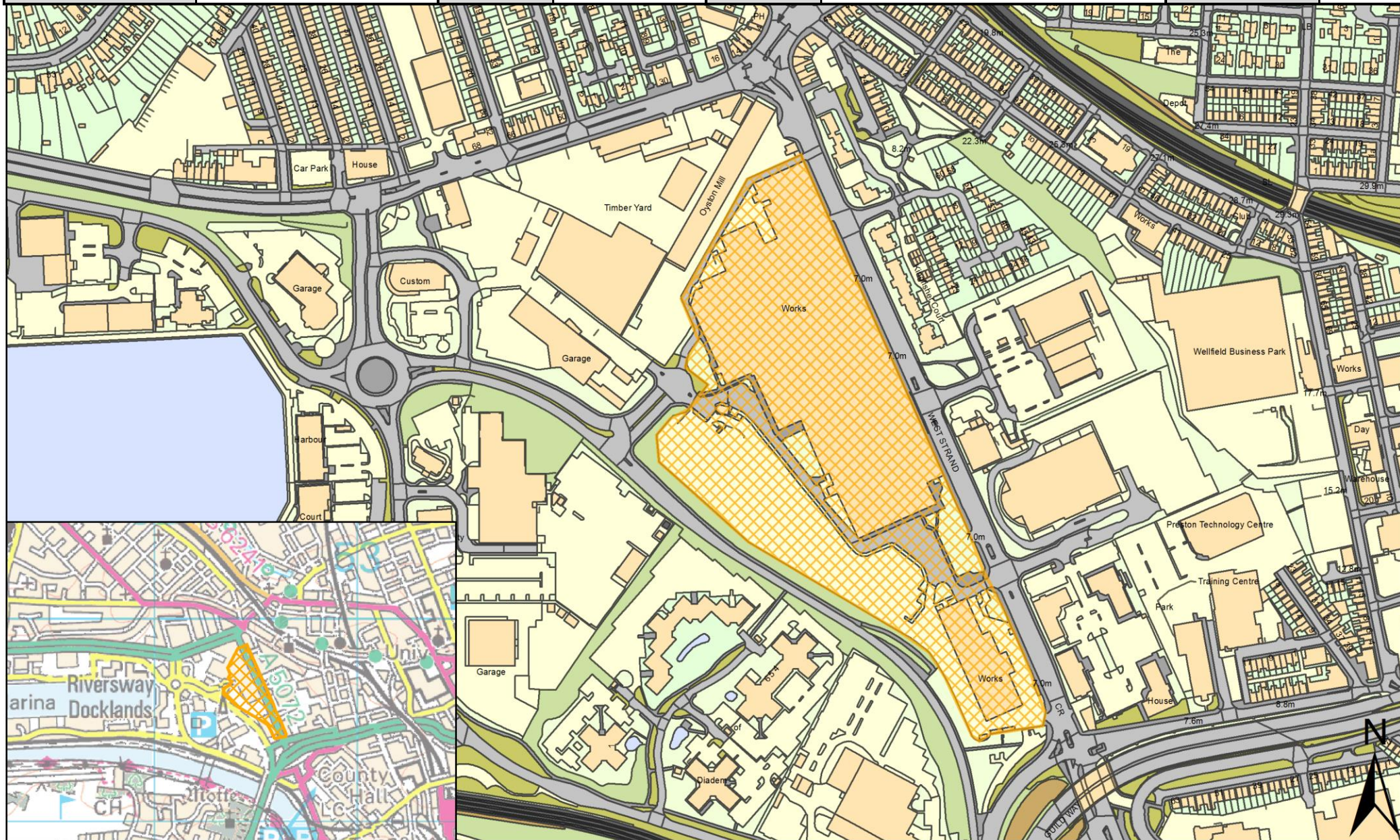



SHELAA Reference	19P140	Call for Sites Reference	<i>Not Applicable</i>	DISTRICT	Preston	WARD	Ashton
Address	Riversway, J N Civils Limited, D2, Chain Caul Road, Preston, PR2 2PD (also PR2 2XL)						
Existing Use	Other	SITE AREA	1.37	PROPOSAL	Employment		PAGE NUMBER 7

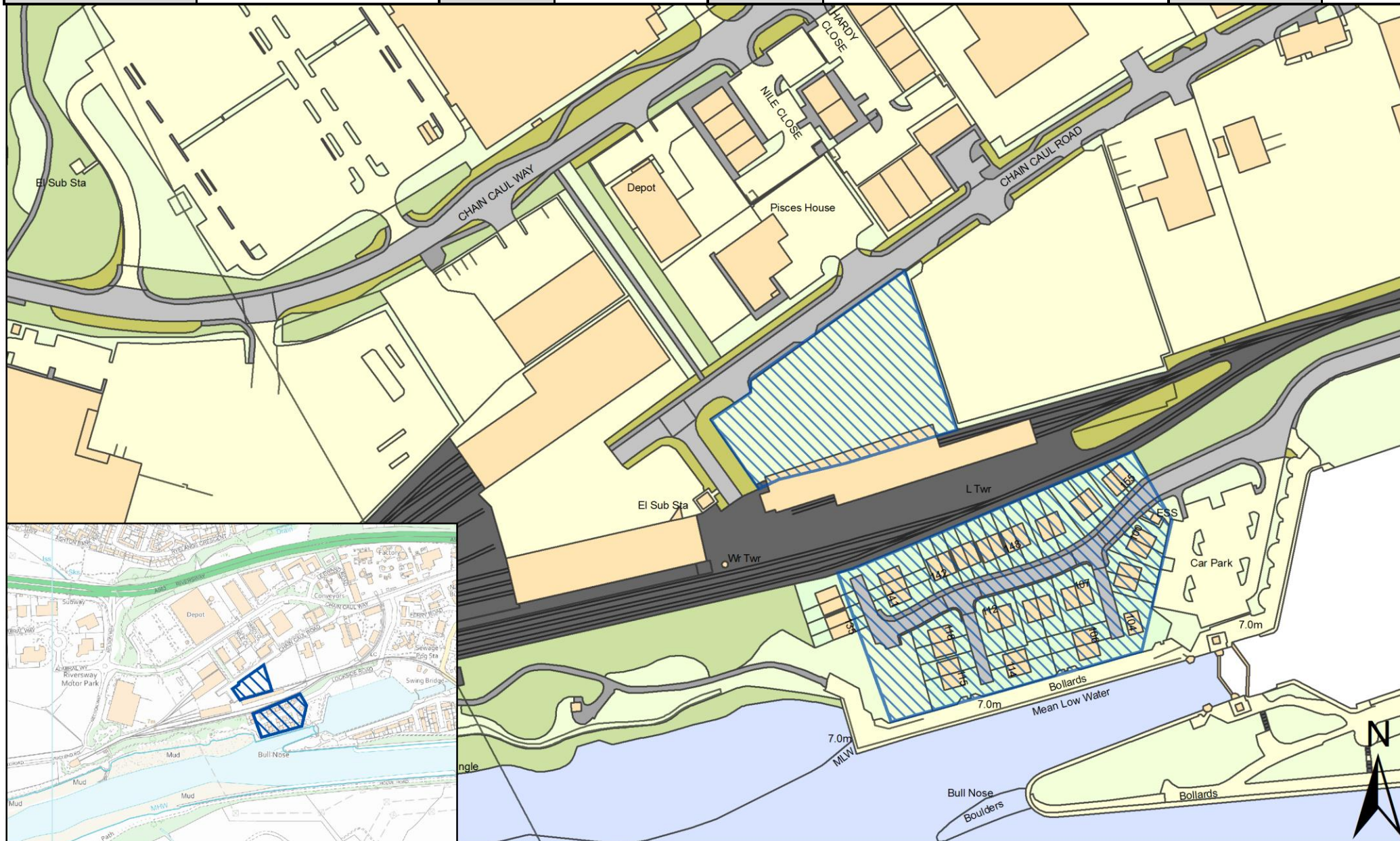



SHELAA Reference	19P155	Call for Sites Reference	<i>Not Applicable</i>	DISTRICT	Preston	WARD	Ashton
Address	Brethrens Meeting Room, Egerton Road, PR2 1AJ						
Existing Use	Other	SITE AREA	0.50	PROPOSAL	Housing		PAGE NUMBER 8

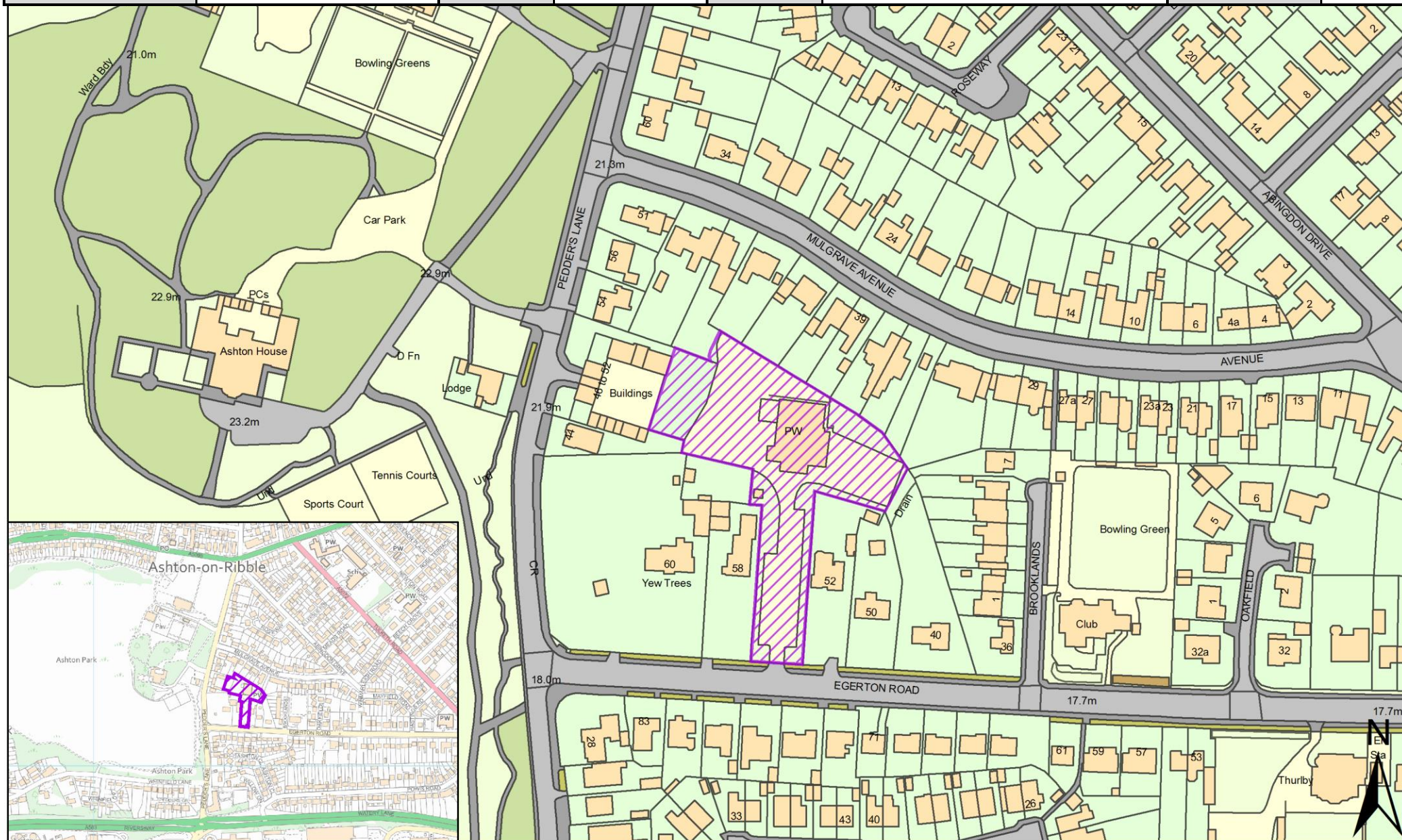



SHELAA Reference	19P178	Call for Sites Reference	<i>Not Applicable</i>	DISTRICT	Preston	WARD	Ashton
Address	Riversway Phase B Site Specific Policy, Maritime Way, Preston, PR2 2HT						
Existing Use	Other	SITE AREA	21.44	PROPOSAL	Mixed Use: Housing and Employment	PAGE NUMBER	9

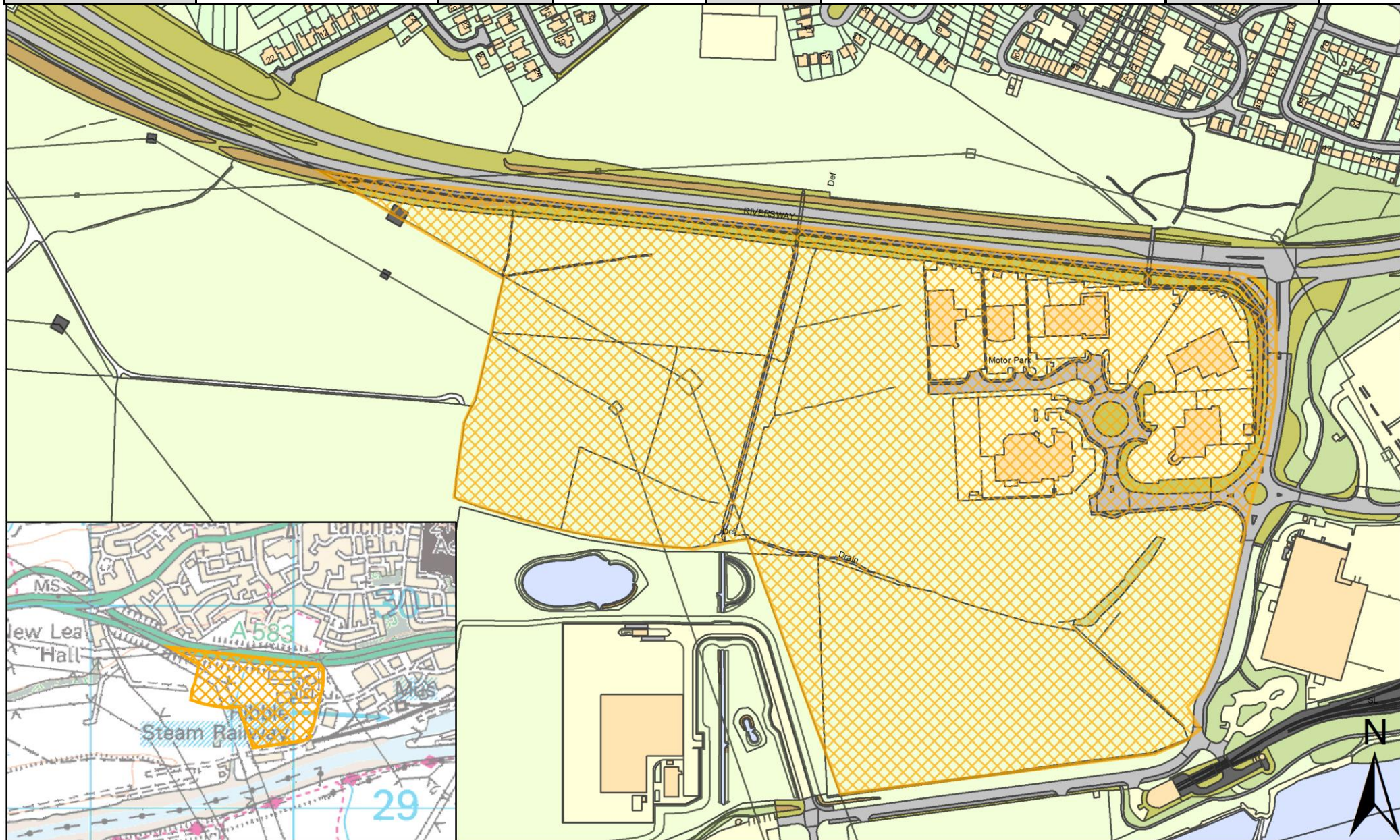



SHELAA Reference	19P198	Call for Sites Reference	<i>Not Applicable</i>	DISTRICT	Preston	WARD	Ashton
Address	Alstoms, Strand Road, PR1 8UG						
Existing Use	Mixed Use	SITE AREA	5.87	PROPOSAL	Mixed Use: Housing and Employment		PAGE NUMBER 10

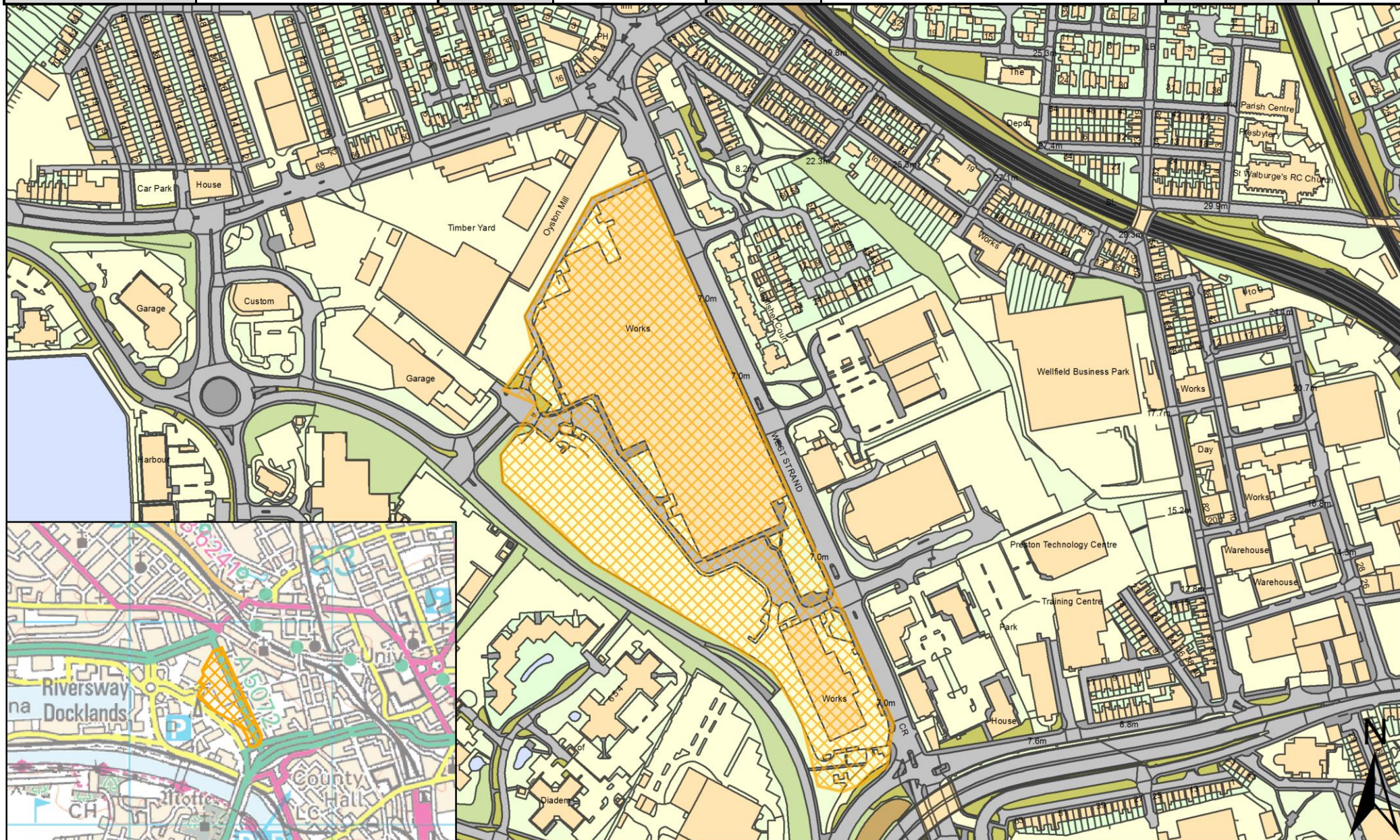



SHELAA Reference	19P212	Call for Sites Reference	<i>Not Applicable</i>	DISTRICT	Preston	WARD	Ashton
Address	147 A Waterloo Road, PRESTON, PR2 1EP						
Existing Use	Vacant	SITE AREA	0.02	PROPOSAL	Housing	PAGE NUMBER	11

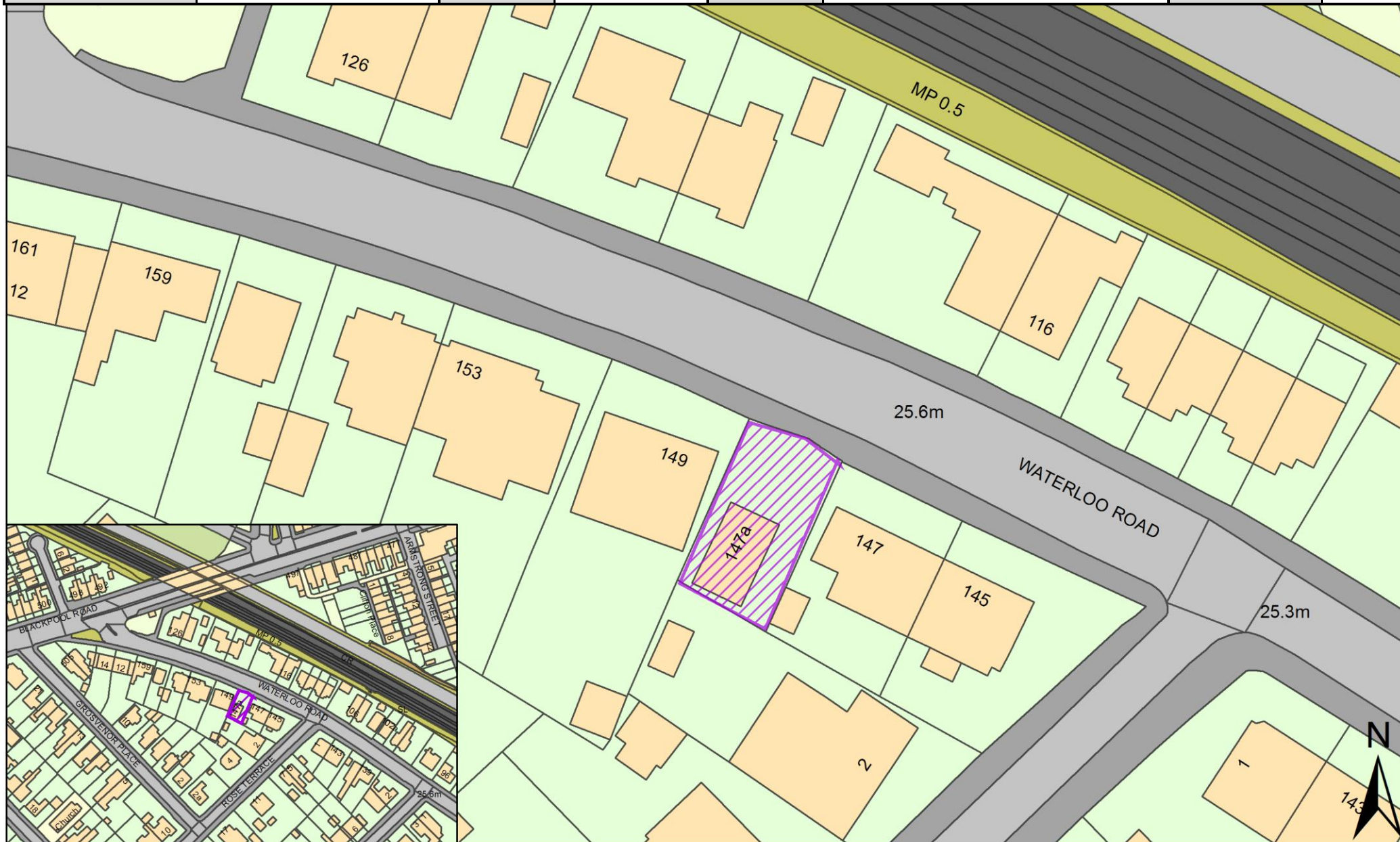



SHELAA Reference	19P228	Call for Sites Reference	<i>Not Applicable</i>	DISTRICT	Preston	WARD	Ashton
Address	507 Blackpool Road, Preston, PR2 1EQ						
Existing Use	Vacant	SITE AREA	0.10	PROPOSAL	Housing	PAGE NUMBER	12

